



Einschraubmutter, Gewindemuffe aus Stahl
Insert, Steel Socket



Einschraubmutter mit **Schlitz**, Stahl verzinkt

Insert with **slotted top**, zinc plated

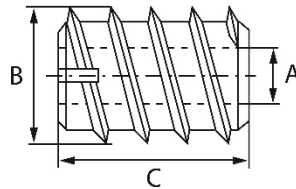

Einschraubmutter mit Schlitz / Insert with slotted top

Artikel-Nr. order-no.	A	B	C	Bohrung drilling	ISK hexagon	VE PU
D01120	M4	ø6,5	8,0	ø5,0	-	200
D01121	M4	ø8,0	8,0	ø6,5	-	200
D01122	M6	ø12,0	10,0	ø10,0	-	200
D01123	M6	ø12,0	12,0	ø10,0	-	200
D01124	M6	ø12,0	15,0	ø10,0	-	200
D01125	M6	ø12,0	18,0	ø10,0	-	200
D01126	M6	ø12,0	20,0	ø10,0	-	200
D01127	M6	ø12,0	25,0	ø10,0	-	200
D01128	M8	ø14,0	15,0	ø12,0	-	200
D01129	M8	ø14,0	18,0	ø12,0	-	200
D01131	M10	ø16,0	18,0	ø14,0	-	100

Einschraubmutter mit **Innensechskant und Bund**, Stahl verzinkt

Insert with **hexagon and collar**, zinc plated

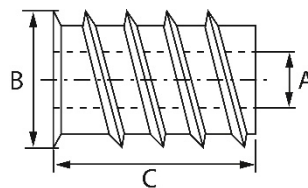

Einschraubmutter mit Innensechskant / Insert, hexagon

Artikel-Nr. order-no.	A	B	C	Bohrung drilling	ISK hexagon	VE PU
D01200	M4	ø8,0	10,0	ø6,5	SW4	200
D01201	M5	ø10,0	12,0	ø8,5	SW5	200
D01203	M6	ø12,0	12,0	ø10,0	SW6	200
D01204	M6	ø12,0	15,0	ø10,0	SW6	200
D01205	M6	ø12,0	18,0	ø10,0	SW6	200
D01206	M8	ø14,0	15,0	ø12,0	SW8	200
D01207	M8	ø14,0	18,0	ø12,0	SW8	200
D01210	M8	ø12,0	18,0	ø10,0	SW6	200
D01209	M8	ø16,0	18,0	ø14,0	SW8	200
D01208	M10	ø18,5	20,0	ø16,0	SW10	100

Hinweis / Please note: Alle Abmessungen in mm / All dimensions in mm